

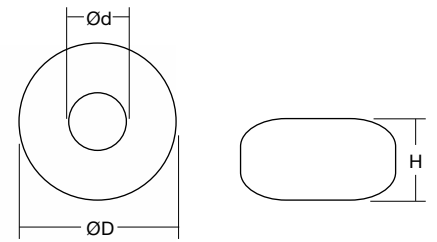

Trasformatori Toroidali
Standard Classe I

Toroidal Transformers
Class I Standard



CE

Articolo Article	Potenza Power VA	Tensione Voltage (in/out) V	Protezione Protection	Dimensioni Dimension			Peso Weight gr.	Omologazioni Approvals
				Ød	ØD	H		
MTT 50-12	50	220/12	PTC	23	68	45	700	
MTT 50-24	50	220/24	PTC	23	68	45	700	
MTT 100-12	100	220/12	PTC	35	96	39	1130	
MTT 100-24	100	220/24	PTC	35	96	39	1130	
MTT 150-12	150	220/12	TA	35	98	45	1500	
MTT 150-24	150	220/24	TA	35	98	45	1500	
MTT 200-12	200	220/12	TA	45	115	45	1990	
MTT 200-24	200	220/24	TA	45	115	45	1990	
MTT 250-12	250	220/12	TA	43	118	48	2100	
MTT 250-24	250	220/24	TA	43	118	48	2100	
MTT 400-12	400	220/12	TA	40	132	57	3600	
MTT 400-24	400	220/24	TA	40	132	57	3600	
MTT 500-12	500	220/12	TA	40	133	68	4100	
MTT 500-24	500	220/24	TA	40	133	68	4100	

- Trasformatori da incorporare IP00.
- Classe termica di isolamento B = 120°C.

- IP00 transformers for integrated installation.
- Thermal insulation class B = 120°C.

- Eventuali potenze e tensioni speciali su richiesta.
- Special power and voltage on request.

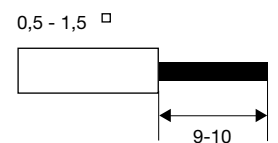

Dati tecnici

Norme di riferimento	EN 61558-; EN 61558-2-6
Tensione	220 V - 12 V 220 V - 24 V
Frequenza	0/50...60 Hz
Potenza	50 ÷ 500 VA

Technical data

Reference Norms	EN 61558-; EN 61558-2-6
Voltage	220 V - 12 V 220 V - 24 V
Frequency	0/50...60 Hz
Power	50 ÷ 500 VA